

# Installation Instructions

**HEN-2432-CAB**

**SUGGESTED TOOLS AND MATERIALS**

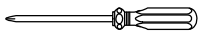

Screwdriver

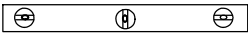

Level



Drill



Tape Measure

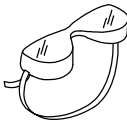

Safety Glasses



Pencil

**PARTS & HAREWARE INCLUDED**



Anchor 7x



Screw 7x



Level 1x

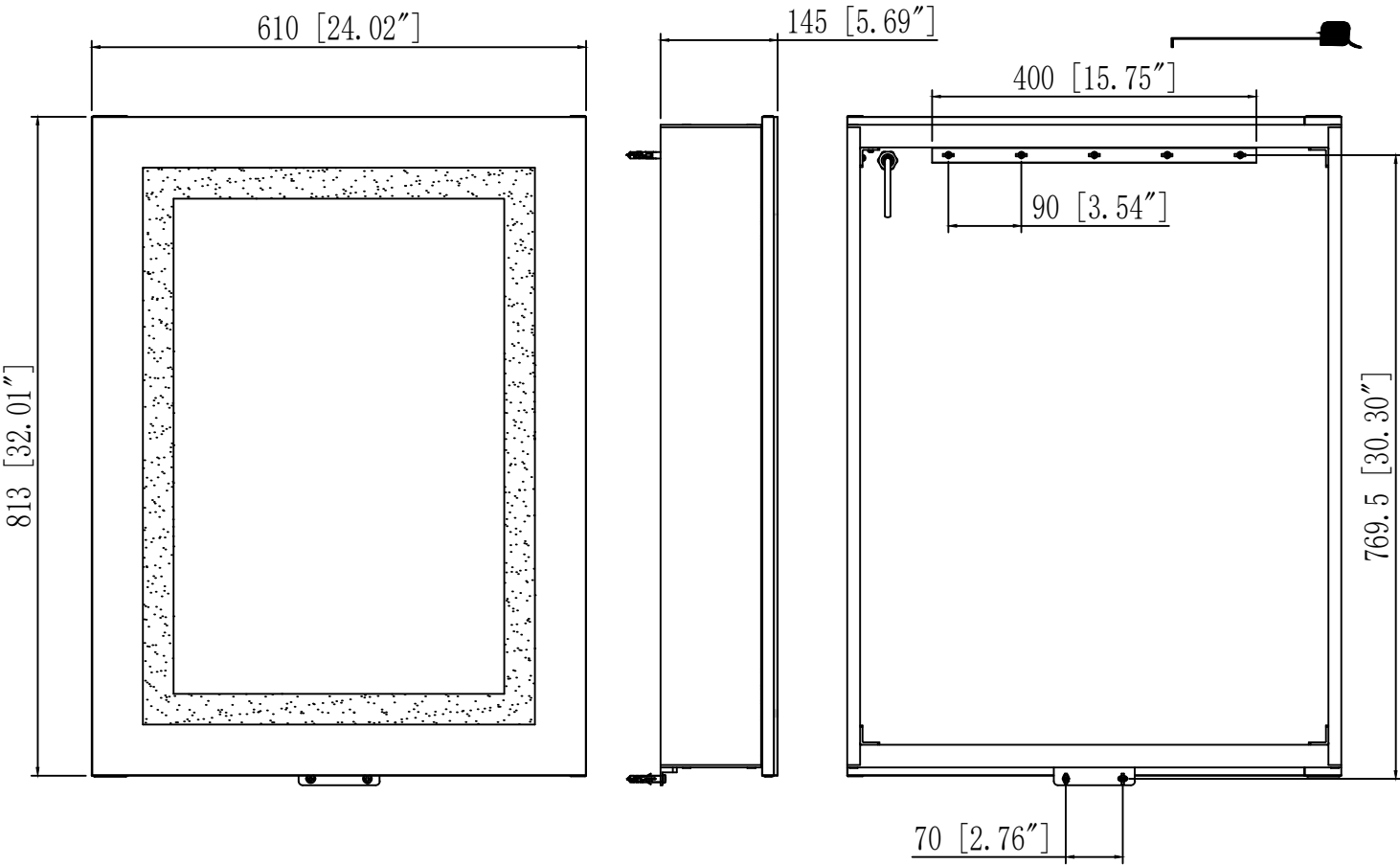

# Installation Instructions

**HEN-2432-CAB**

**SUGGESTED TOOLS AND MATERIALS**

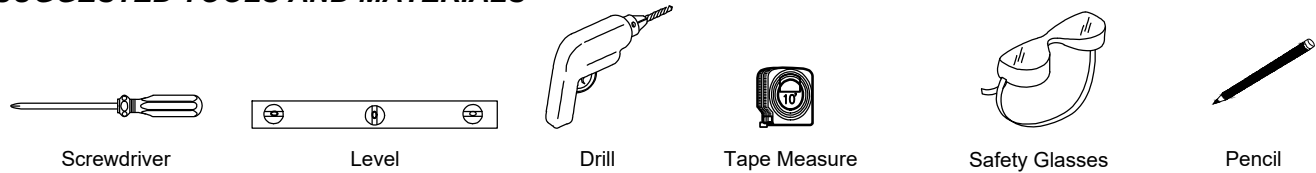

**PARTS & HAREWARE INCLUDED**

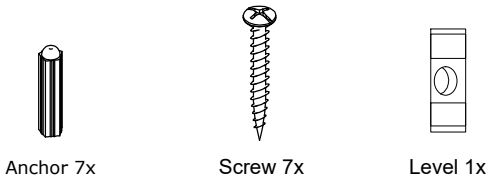

**INSTALLATION INSTRUCTIONS**

1

400 [15.75"]

90 [3.54"]

Level

1.

2.

1>Level the hanging cleat with a level ruler and mark the installation hole position of the hanging cleat with a pencil.  
2>Drill holes.

2

Insert the anchors into the wall(Use at least 5 anchors).

3

Wall

Install the hanging cleat into the wall.  
Use 5x45mm screws to hanging cleat to wall(Use at least 5 screws).

4

Wiring from light fitting

Neutral Wire			white(N)
Earth(green/yellow)			Green/yellow
Live Wire			black(L)

5

6

70mm

DETAIL

DETAIL

# Installation Instructions

***HEN-2432-CAB***

## ***SUGGESTED TOOLS AND MATERIALS***

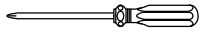

Screwdriver

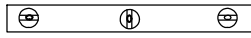

Level



Drill



Tape Measure

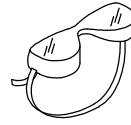

Safety Glasses



Pencil

## ***PARTS & HAREWARE INCLUDED***



Anchor 7x

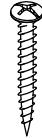

Screw 7x



Level 1x

## ***FIXING INSTRUCTIONS FOR THE ADJUSTABLE GLASS SHELVES***

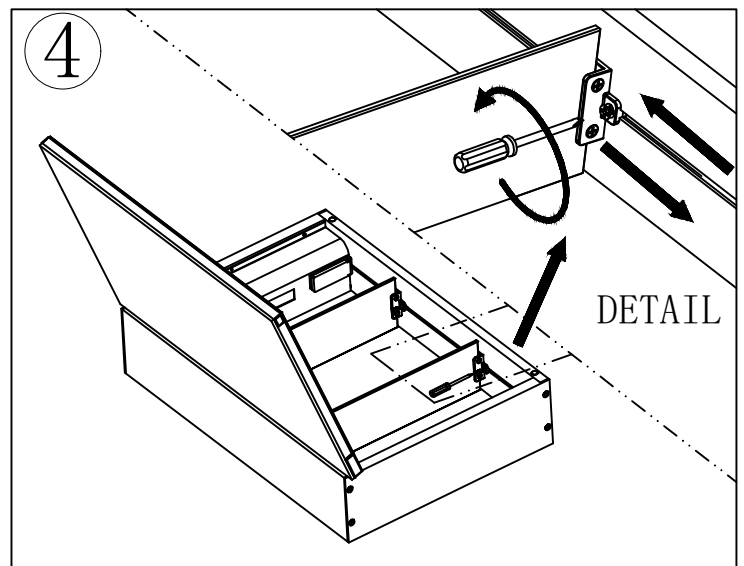
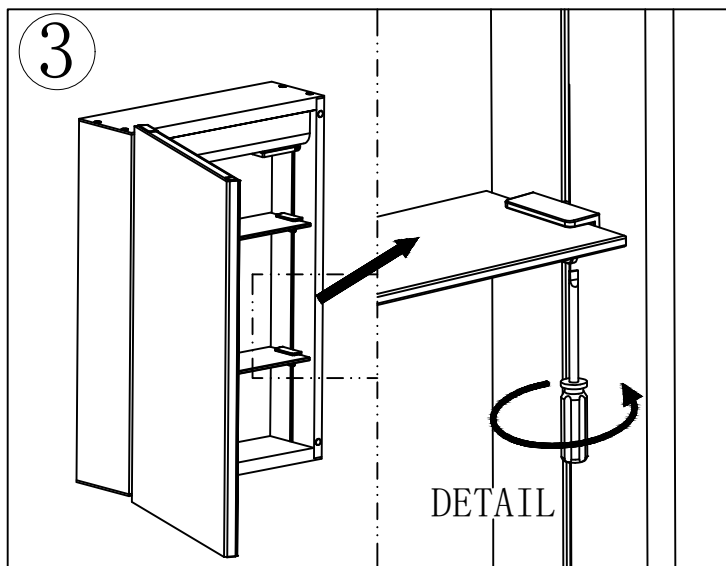
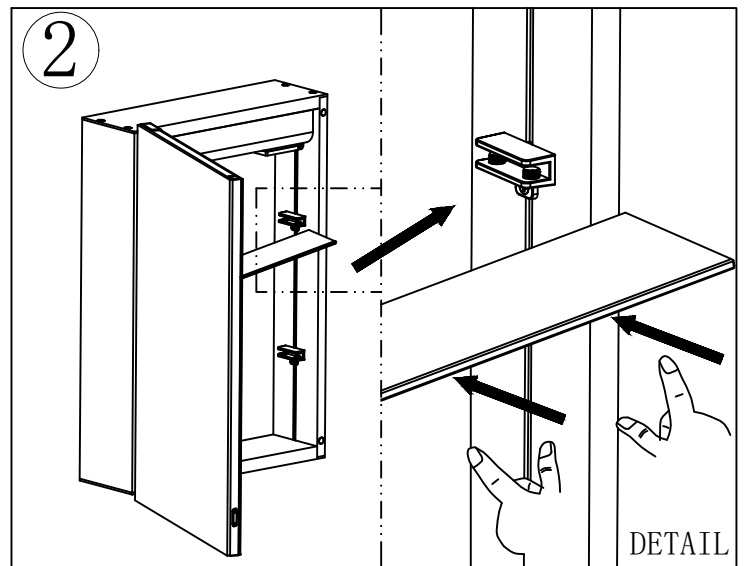
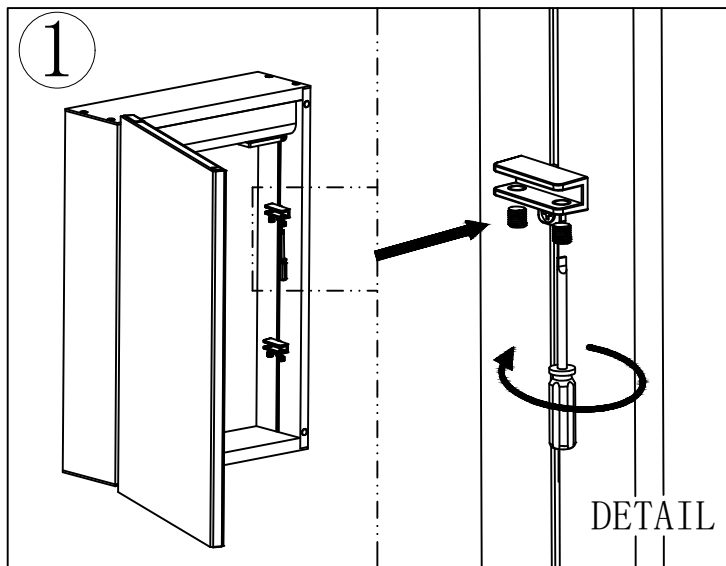

# Installation Instructions

***HEN-2432-CAB***

**SUGGESTED TOOLS AND MATERIALS**

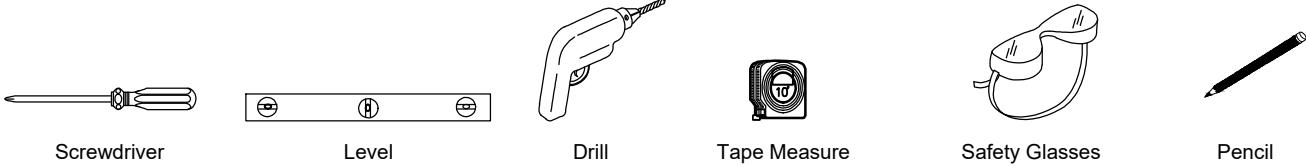

**PARTS & HAREWARE INCLUDED**



**THE DRAWINGS FOR THE ADJUSTMENT OF THE SOFT CLOSE HINGES**

